

# V35高音规格书 / 低音规格书/ 箱体规格书

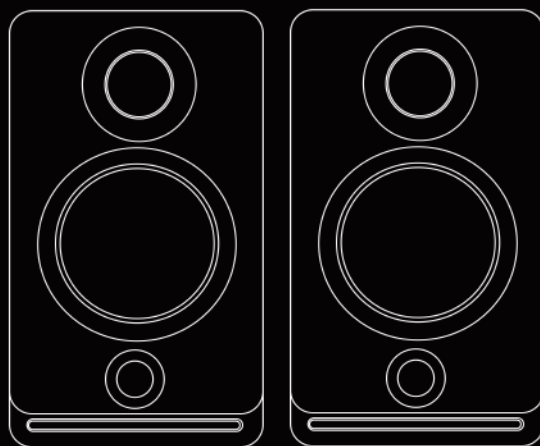

# 高音规格书 ( V35 )

---

品名：V35 高音

本厂型号：TW28-80 B      尺寸：Φ 48.1 \*3 1.6

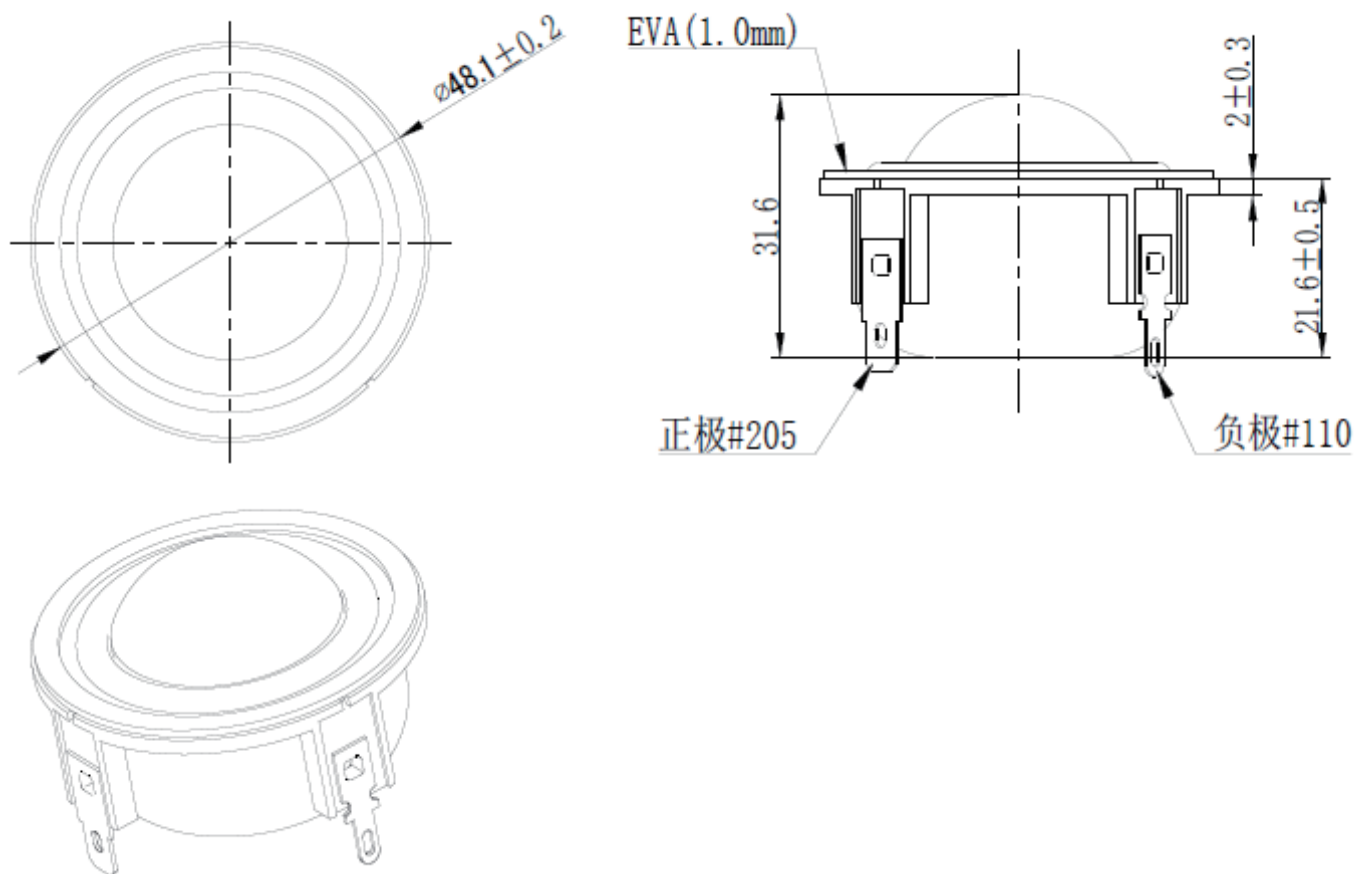

# 高音规格书 ( V35 )

编号	项目 Item	规格 Specification	测试条件 Test Conditions
1	标称阻抗 Nominal impedance [ohm]	8 ohm ±15%	At 1 V 3.5 KHz
2	额定阻抗 Nominal impedance [ohm]	6.6 ohm ±15%	
3	谐振频率 Free air resonance	1300 Hz ±20%	LMS Test
4	动作实验 Operation Test	Must be normal at program Source	Sine wave <u>8.9</u> V, F0-20KHz 串接 3.3μF/50V 电容
5	异常音 Buzz Ration Test	Must be normal at Sine Wave	Sine wave <u>2</u> V, 200-20KHz
6	实际频率范围 Ated Freq. Range	F0- <u>20</u> K Hz	SPL-10dB At 1W Axial Calayate From 1M Measurment Average
7	额定输入功率 Ated Power Input	10W	最大输入功率 Max Power Input 30W
8	音圈规格 Voice coil spec.	Former <u>ASV</u> wire <u>CCA</u> DCR <u>6.0</u> Ω Winding height <u>1.74</u> layers <u>2L</u> Inside diameter <u>28</u>	
9	磁路 Magnet structure	front plate thickness <u>2</u> mm Back plate thickness <u>2.5</u> mm Magnet size <u>Φ27*Φ10*7H N38SH/Φ24.5*Φ8*3.5 N35</u> Magnet weight <u>---</u> g ( ) Ferrite ( <input checked="" type="checkbox"/> ) Neodymium	
10	纸盆 Paper basin	Surround material <u>SILK</u> Cone material <u>SILK</u>	
11	磁束密度 Flux Density	14000 Gauss	
12	连续负载 Load Test	After test meet item 2 and 3	串接 3.3 μF/50V 电容 10W/8ohm 100Hous
13	输出音压 Output SPL	Tweeter <u>89</u> dB+/-2cB(at 3.0K, 4.0K, 8K, 16KHz 1m/1w) Woofer <u>---</u> dB+/-2dB (at 0.3, 0.4, 0.5, 0.6KHz) LMS test	
曲线管控： 1KHZ--2KHZ: ±2.5dB ; 2KHZ--20KHZ: ±2dB			

# 高音规格书 (V35)

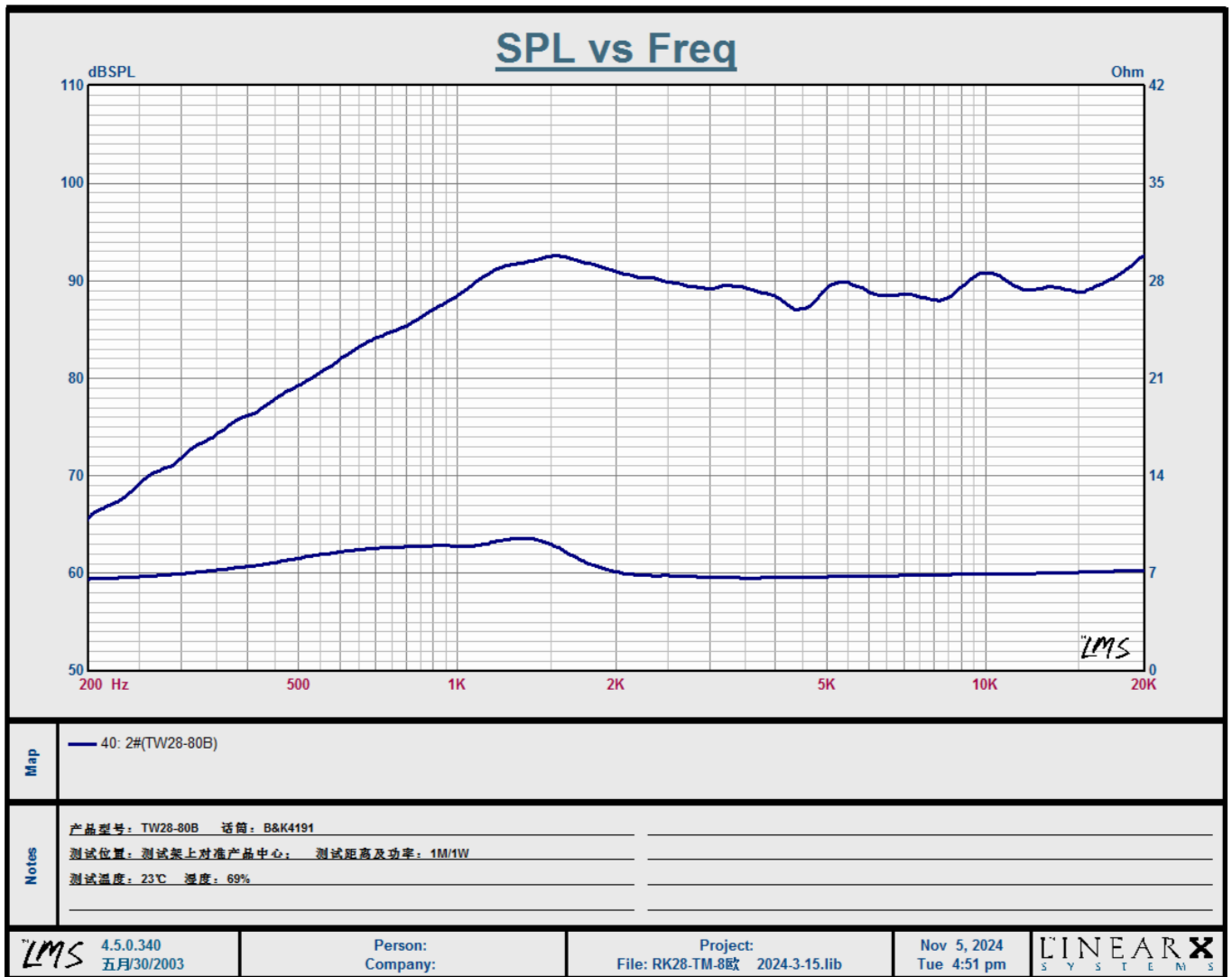

# 低音规格书 ( V35 )

---

品名： V35 低音

本厂型号： WF100-143B 尺寸： 130.5mm\*71mm

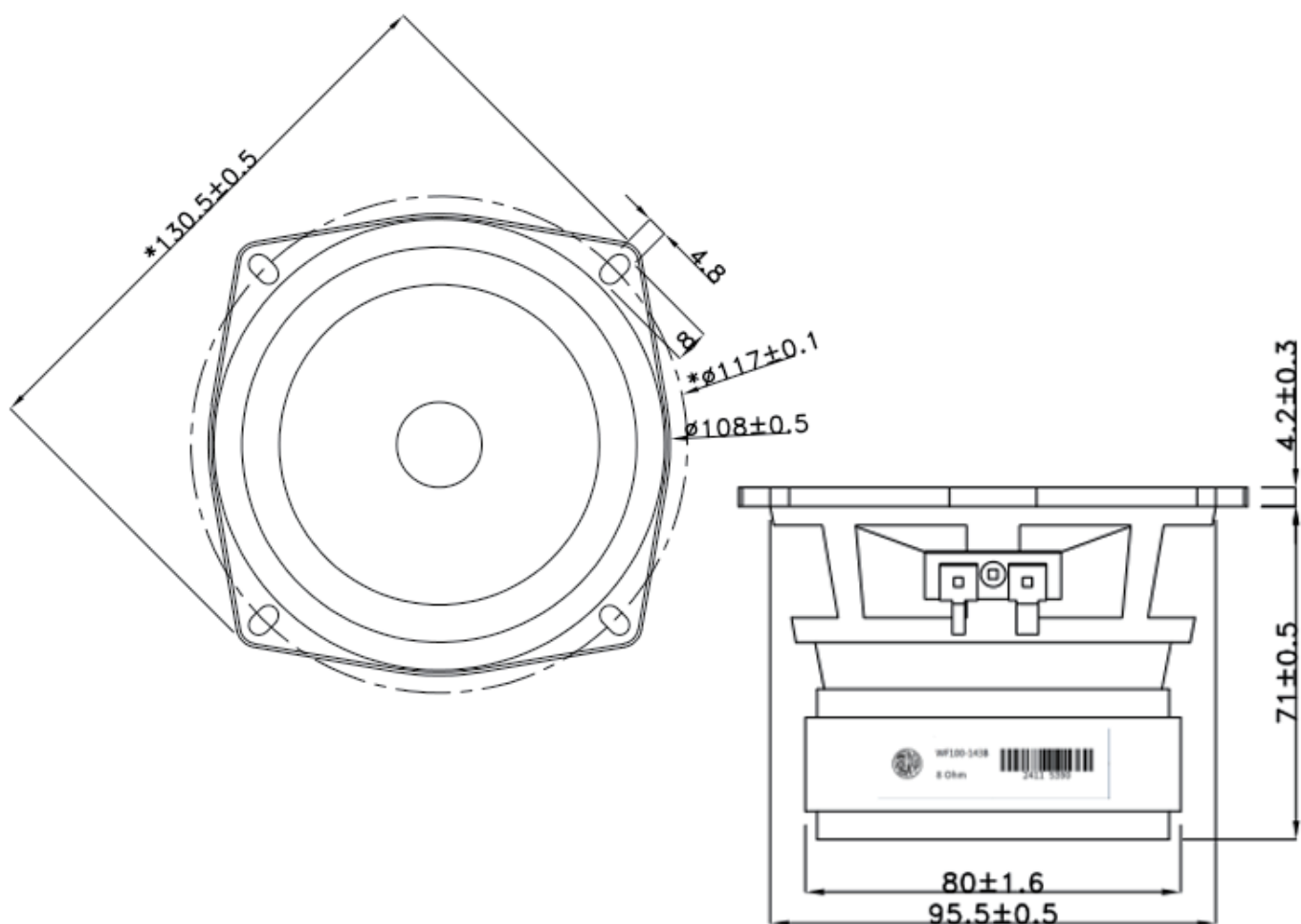

# 低音规格书 ( V35 )

序号	项目 Item	规 格 Specification		测试条件 Test Conditions
1	标称阻抗 Nominal impedance [ohm]	8ohm		--
2	额定阻抗 Rms rate	7.981ohm±15%		At 1V 350Hz
2	谐振频率 Free air resonance	98 Hz±15%		LMS Test
3	异常音 Buzz Ration Test	Must be normal at Sine Wave		Sine wave 10.9V, 98HZ-6KHZ
4	实际频率范围 Ated Freq. Range	F0- <u>3</u> KHz		SPL-10dB At 1W Axial Calayate From 1M Measurment Average
5	额定输入功率 Ated Power Input	15 W	最大输入功率 Max Power Input	30 W
6	音圈规格 Voice coil spec.	Former <u>KSV</u> wire <u>CCAW</u> DCR <u>7.2Ω</u> Winding height <u>10.8mm</u> layers <u>2L</u> Inside diameter		
7	磁 路 Magnet structure	Magnet size <u>90*40*20 Y30</u> Magnet weight <u>--</u> g ( <input checked="" type="checkbox"/> ) Ferrite ( <input type="checkbox"/> ) Neodymium		
8	纸 盆 Paper basin	Surround material <u>Rubber</u> Cone material <u>Paper</u>		
9	连续负载 Load Test	After test meet item 2 and 3	15W/ 8ohm 100Hours	
10	输出音压 Output SPL	Woofer <u>86 dB+/-3Db</u> (at 100, 200, 400, 800, 1.6k 1m/1w) LMS test		
有效辐射面积 Eff. diaphragm Area		5.281kmm	同振质量 Moving mass	5.029g
机电转换因子 Force facto BL		5.861	等效容积 Equivalent volume VAS	2.089 Lrt
机械 Q 值 Mechanical Q Factor Qms		10.0	电 Q 值 ElectricalQ Factor Qes	0.647
总 Q 值 Total Q Factor Qts		0.608	音圈电感 Voice coil inductance	248.195uH

# 低音规格书 (V35)

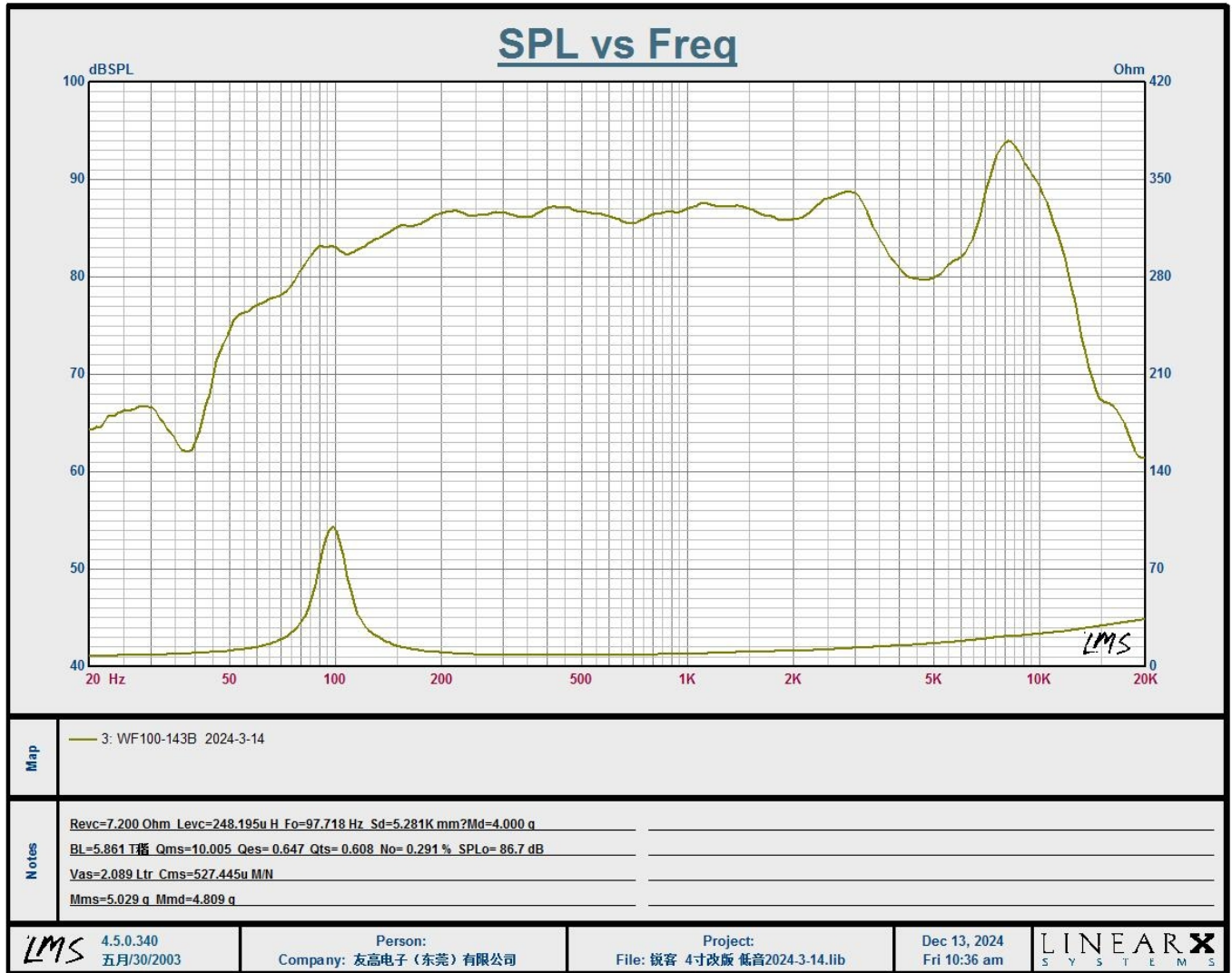

# 箱体规格书 ( V35 )

---

品名：V35

本厂型号：SW0402-17-B 尺寸：270\*155\*188mm

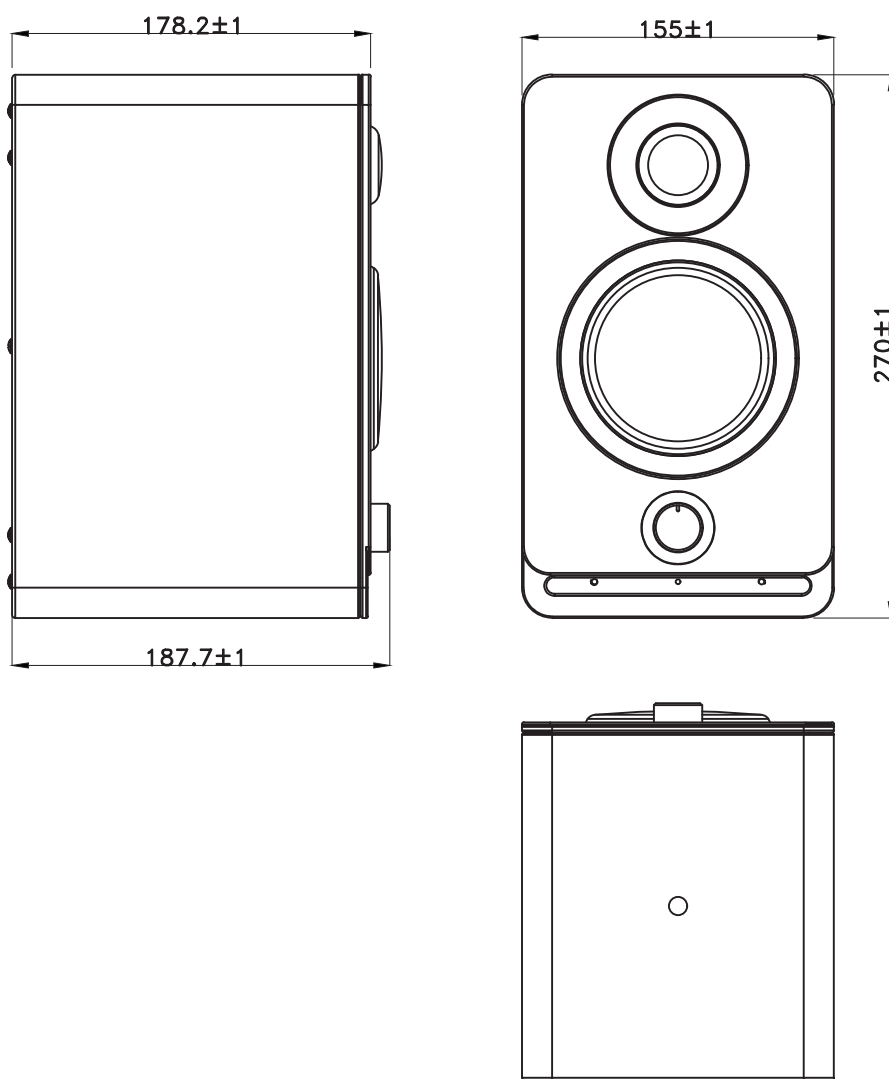

# 箱体规格书（V35）

序号	项目 Item	规格 Specification	测试条件 Test Conditions
1	标称阻抗 Nominal impedance [ohm]	_____	_____
2	谐振频率 Free air resonance	65 Hz ± 20%	LMS Test
3	异常音 Buzz Ration Test	Must be normal at Sine Wave	Sine wave 20V, 20HZ-20KHz, 旋钮顺时针扭到最大档位
4	实际频率范围 Ated Freq. Range	F0- <u>20</u> K Hz	SPL-10dB At 1W Axial Calayate From 1M Measurment Average
5	额定输出功率 Ated Power Output	60 W	最大输出功率 Max Power Output 120 W
6	音圈规格 Voice coil spec.	Former ___ wire ___ DCR ___ Winding height ___ layers ___ Inside diameter	
7	磁 路 Magnet structure	Magnet size ___ Magnet weight ___ g ( ) Ferrite ( ) Neodymium	
8	纸 盆 Paper basin	Surround material ___ Cone material ___	
9	磁束密度 Flux Density	___ Gauss	
10	连续负载 Load Test	After test meet item 2 and 3	1KHz 校准信号 最大功率档 70V 测试信号: EIA-426B 100H
11	输出音压 Output SPL	SPEAKER 90 dB ± 2 (AT 200Hz、600Hz、800KHz、2KHz、4KHz、6KHz、8KHz 1M/1W)	

# 箱体规格书 ( V35 )

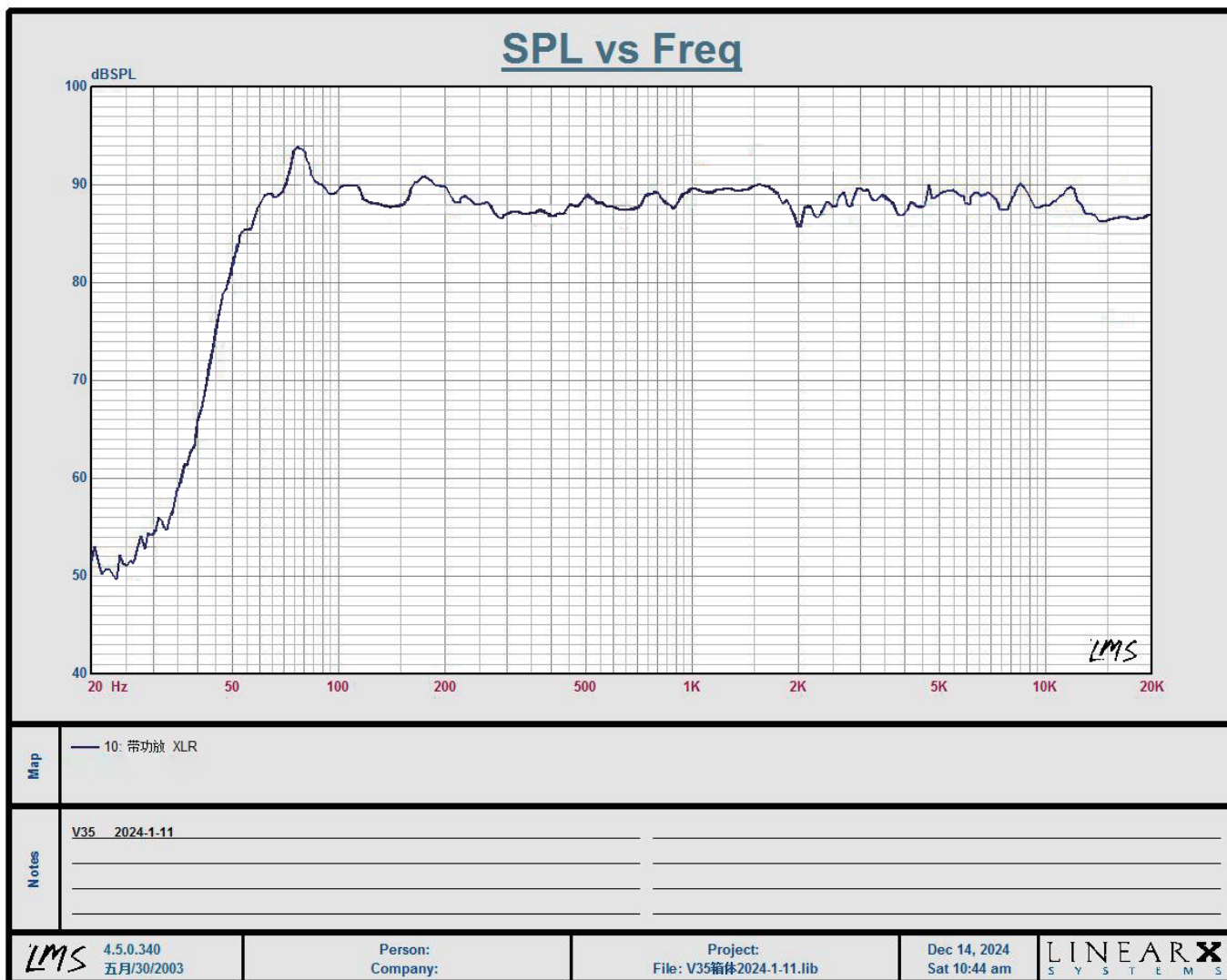

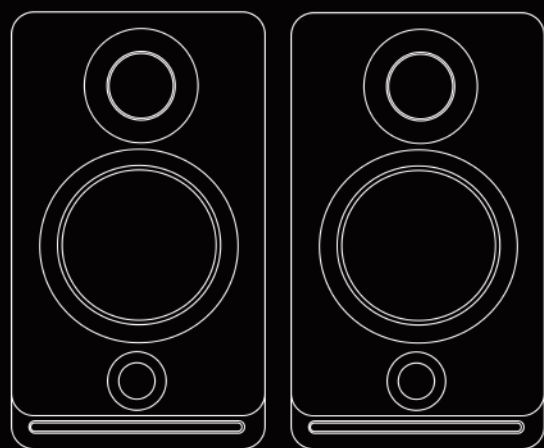

沁园春

真声音·真品质·真价格

Real Sound / Real Quality / Real Price